

Radisson **BLU**
HOTEL
AT DISNEYLAND® PARIS

MEETINGS MADE EASY

PARIS

EXPERIENCE
MEETINGS

HOTELS DESIGNED TO SAY YES!
radissonblu.com/meetings

WELCOME

Nestled in the heart of the golf and only a few minutes away from the Disney® Parks, the Radisson Blu Hotel is easily accessible for a national and international clientele. Its free shuttle service connects the hotel to the largest TGV/RER station in France in only 7 minutes. 108 stations are serviced, therefore connecting to all regions in France.

For international collaborators, the station has daily direct trains from London and Brussels (respectively 3 hours and 1 1/2 hours). Finally, for those arriving by plane, nothing could be simpler: 70 daily trains connecting the station to the Charles de Gaulle airport in only 10 minutes.

This extremely accessible location is halfway between capital city and the Champagne region and makes this green heaven an excellent destination for a business clientele from around the world.

EXPERIENCE MEETINGS

Experience Meetings by Radisson Blu is a concept that ensures successful meetings by harmonizing the tangibles: breakout rooms, connectivity and food with the intangibles such as: service, satisfaction and sustainability.

An integral part of Experience Meetings is **Brain Food**, an innovative approach to healthy menus which is developed to support efficiency and ability to concentrate.

Brain Box touches upon all the senses with walls you can write on, with colors that spark your brain and flexible furniture that give you the space to think. And, Experience Meetings makes it easy for you to go online when you meet with **free Internet** for all meeting delegates.

Plus each time you book a meeting or event at the Radisson Blu Hotel, at Disneyland® Paris you can earn Gold Points® within our Club CarlsonSM for Planners programme. Sign up now at clubcarlson.com and you can start earning points for Award Nights, upgrades and much more.

BRAIN FOOD
FOR MEETINGS

BRAIN BOX
BREAK-OUT ROOM

(((FREE
INTERNET)))





MEETINGS & EVENTS

The Radisson Blu Hotel offers its experience and knowhow to organise your events and guarantees 100% satisfaction.

Its 15 meeting rooms all benefit from natural daylight and are comfortable, convertible, spacious and functional. Add 12 convertible rooms and you have 27 meeting rooms in all!

Almost 1 200 sqm of space are dedicated for you, including our luminous grand foyer which can accommodate your coffee breaks, traditional or themed. Once the weather permits all your breaks can be transferred to our terrace, adjacent to the meeting rooms and with impressive views on the golf course.

Smaller meetings or complete privatisation of the hotel, our dedicated team will be by your side to help you organise your event with flexibility and professionalism. You will always be in contact with a unique event organiser, always available. Quality and success of your event is our priority!

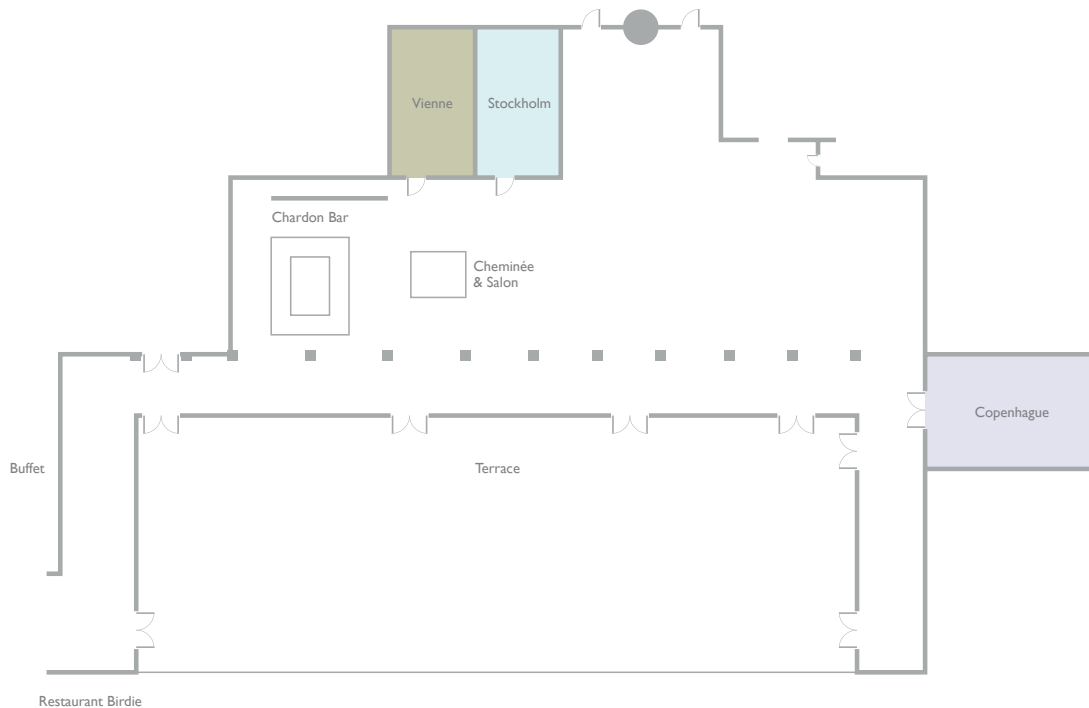

Restaurant Birdie

MEETING ROOM CAPACITY

MEETING ROOM	Board-room	Cabaret style	Classroom	Theatre style	U-shape	Dinner	Reception / Cocktail	Length and width sq feet	Height	Total sq feet
Paris 1	38	42	78	105	38	80	130	12.5 x 8.4	2.8	105
Paris 2	38	36	78	100	38	70	110	12.5 x 7.1	2.8	88.75
Paris 3	38	36	78	100	38	70	122	12.5 x 7.8	2.8	97.75
Paris 1+2	50	72	119	190	50	110	230	12.5 x 15.5	2.8	193.75
Paris 2+3	50	72	119	190	50	110	230	12.5 x 14.9	2.8	186.25
Paris 1+2+3	-	120 160 en 3/4 de lune	190	300	-	160	375	23.7 x 12.5	2.8	296.25
Marseille	28	18	38	55	30	-	-	10.15 x 5	2.8	50.75
Lyon	20	12	25	40	20	-	-	8 x 4.35	2.8	34.8
Rome	20	12	25	40	20	-	-	8 x 4.35	2.8	32
Bordeaux	20	12	25	40	20	-	-	7.8 x 4.4	2.8	34.32
Berlin	20	12	25	40	20	-	-	8.5 x 3.8	2.8	32.3
Brussel	20	12	25	40	20	-	-	8.3 x 3.7	2.8	30.71
Nice 1	18	-	16	25	20	-	-	7 x 3.7	2.8	25.9
Nice 2	18	-	16	25	20	-	-	7 x 4	2.8	28
Nice 3	18	-	16	25	20	-	-	7 x 3.8	2.8	26.6
Nice 1+2	25	18	30	50	25	30	60	7 x 7.7	2.8	53.9
Nice 2+3	25	18	30	50	25	30	60	7 x 7.8	2.8	54.6
Nice 1+2+3	34	30	50	100	35	60	100	7 x 11.6	2.8	81.2
Vienne	18	12	25	40	20	-	-	7.8 x 4.4	2.8	34.32
Stockholm	18	12	25	40	20	-	-	7.8 x 4.4	2.8	34.32
Copenhagen	22	18	25	30	22	-	-	7.8 x 4.4	2.8	34.32
Foyer	-	-	-	-	-	-	200	16.2 x 7.20	-	-
Terrasse	-	-	-	-	-	150	-	-	-	-
Birdie 1+2	-	-	-	-	-	110	-	-	-	-
Birdie 3+4	-	-	-	-	-	160	-	-	-	-
Birdie 4	-	-	-	-	-	80	-	-	-	-
Birdie	-	-	-	-	-	300	-	-	-	-

ROOMS & SUITES

Opened since December 2005, this hotel has 250 spacious rooms including 18 suites. In a contemporary and warm atmosphere, the rooms are decorated in two distinct styles: one modern in red and wenge wood and the other, classical, with orange tones and white light-coloured wood. All our rooms have an exceptional and breathtaking view on the golf course and the surrounding area which extends over 6 kms.

Of course they are all equipped with air conditioning, direct phone, minibar, flat screen cable television, individual safe, free high speed internet, hairdryer, iron and ironing board.

For a VIP treatment choose our Business class rooms; these rooms offer a Nespresso® machine, bathrobe and buffet breakfast included.

To best respond to all your requests, our “One Touch Service” offers round the clock assistance with just a push of a button!

RESTAURANT & BAR

Our restaurant team completes the success of your event. Either as a buffet or a table service menu, our Chef loves offering rich-flavoured dishes composed with fresh and seasonal products.

Our Pamplemousse restaurant, elegant and modern, welcomes your groups for up to 85 people. It can be totally privatised according to the chosen format. The Birdie restaurant, in warmer tones, is convertible according to the size of your groups. It also welcomes clients for the “super buffet breakfast”. Finally our terrace can also accommodate up to 200 people and, weather permitting, offers many different menus around our barbecue. Exceptional, with its immense open chimney, the bar “Le Chardon” is warm and invites you for relaxing after a hard day of work.

AFTER YOUR MEETINGS...

The Radisson Blu, thanks to its immense green space, offers numerous possibilities for outdoor activities. Surrounding our gardens, the Golf, with its three 9-hole courses, can offer golf initiations for up to 150 people. Finally many activities can be offered from the hotel (buggy, 4x4...) or only a few minutes away.

After the exertion, relaxation! The hotel has a wellness center, with only one thought in mind: your well-being! Indoor pool, sauna, steam bath, all open from 6am to 11pm. Disney® is of course a few minutes away and the region is also rich in history and various excursions can be organised from the hotel for a total getaway.

Finally for your gala evenings, besides the different castles situated near the hotel, other activities and places can be suggested such as visits to the Champagne cellars.

Yes, surprise your collaborators by offering a themed visit to these cellars and spend the evening with dinner in an authentique atmosphere.



BRAIN FOOD
FOR MEETINGS

BRAIN BOX
BREAK-OUT ROOM

FREE
INTERNET

100% SATISFACTION
GUARANTEE

Club
CARLSON
FOR PLANNERS

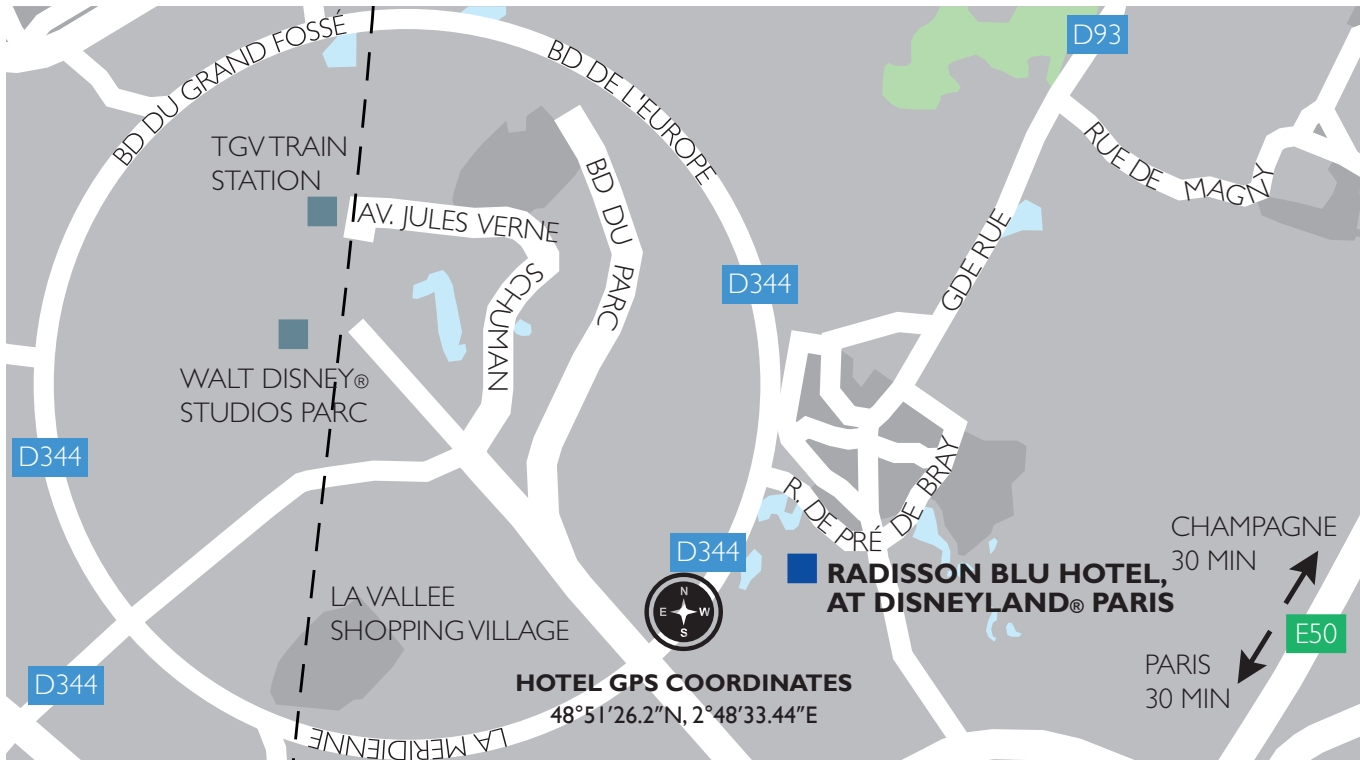

ARRIVAL

By Car: From Paris take the A4 towards Reims and take exit number 14 – Parcs Disney®. Take the second exit: Marne la Vallée/Val d'Europe – Magny le Hongre. Turn right, follow Magny le Hongre. Take the first right direction "Golf". Take the first right towards Hotels du Golf. At the end of the road you have arrived!

By Train from Paris: Take the RER A towards Marne la Vallée-Chessy. Get off at the Chessy Marne la Vallée station and take the private Radisson Blu shuttle situated next to the car park, theme parks.

By TGV/Thalys/Eurostar: And from the Charles de Gaulles Airport Get off at the Chessy Marne la Vallée station and take the private Radisson Blu shuttle situated next to the car park, theme parks.

RADISSON BLU HOTEL, AT DISNEYLAND® PARIS

Allée De La Mare Houleuse
77700 Magny Le Hongre, France
T: +33 (0)1 60 43 64 00 F: +33 (0)1 60 43 64 01
radissonblu.com/golfresort-paris